

Operation & Maintenance Instructions

for GU-SECURY Automatic Door Lock and Lever Handle

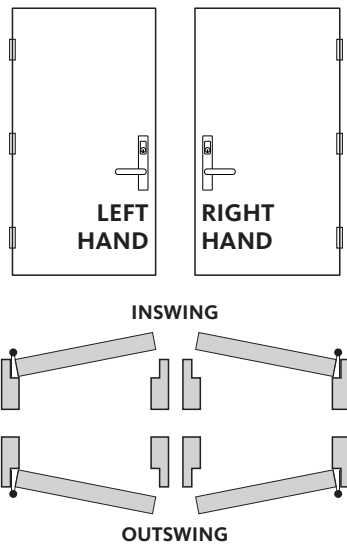

HANDLE HANDING (VIEWED FROM OUTSIDE)



CARE & MAINTENANCE

To prevent build-up of surface contaminants possibly resulting in hardware surface deterioration and in some case appearance of rust; we recommend to wipe down with soft cloth all visible surfaces with warm water and mild soap. Then wipe the same surfaces with a clean cloth and warm water only and let surfaces dry completely. This procedure should be done a minimum of 2 times per year. The use of caustic cleansers or chemicals should be avoided.

For the handle set, all finishes except Oil Rubbed Bronze (O5), it is strongly recommended to apply a non-abrasive automotive wax to protect the surface.

In order to ensure the smooth operation of the lock over a long period of time, it is necessary to lubricate all movable parts and locking points (🔑) using acid and resin-free lubricants.

Ferco Architectural Hardware Inc.
2000, Rue Berlier
Laval QC H7L 4S4
T 450.973.1437
F 450.973.7661
1.800.355.8810
www.ferco.ca

CLOSING & LOCKING

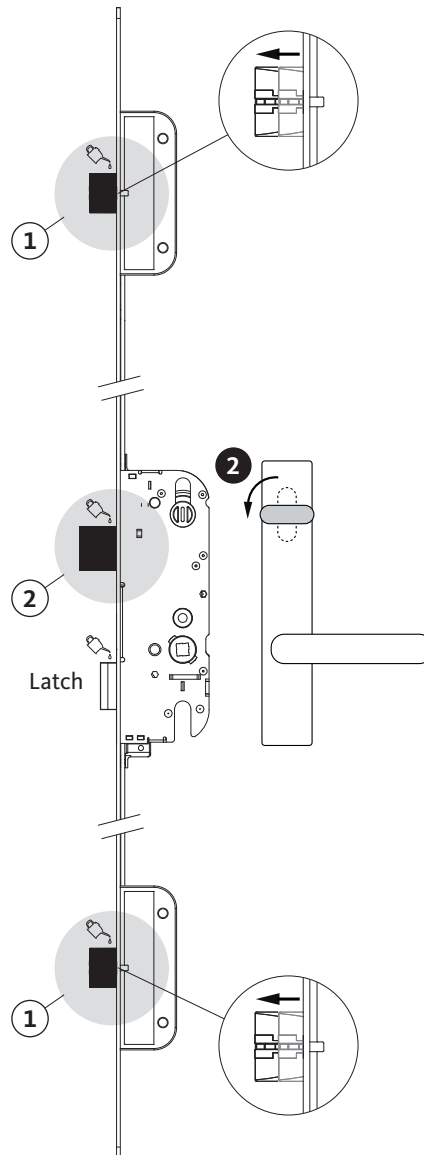

- ① **DON'T NEED TO LIFT THE HANDLE**
As soon as the door closed, the Automatic latchbolts instantly throw 20mm and are secured to prevent them from being forced back.
- ② Operate the cylinder or the knob with a single 90° turn to engage the dead bolt and lock the mechanism.

UNLOCKING & OPENING

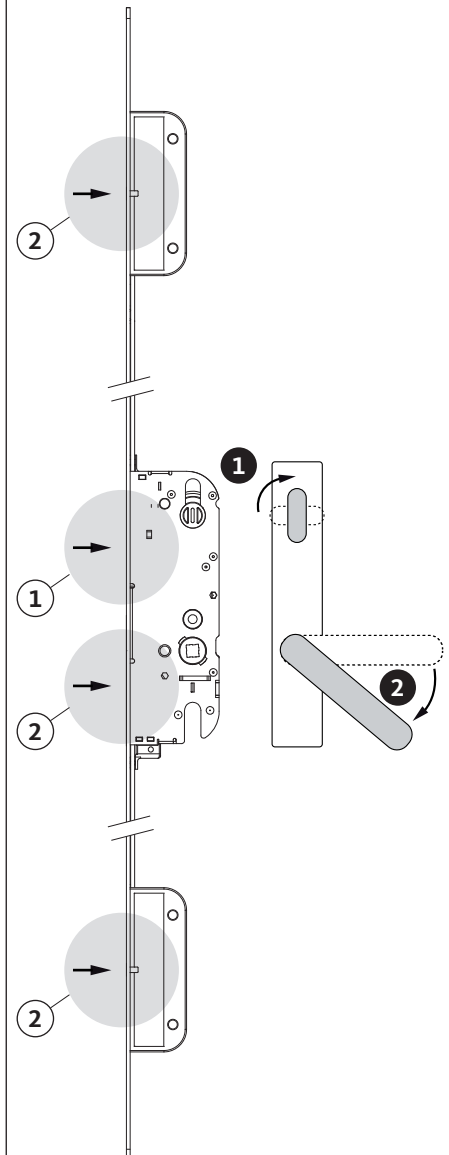

- ① Withdraw the dead bolt and release the mechanism by operating the cylinder or the knob with a single 90° turn.
- ② Press down the lever to withdraw the locking points and open the door.

Securing technology for you

